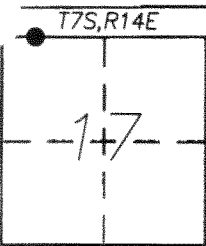

# CORNER RECORD

Document Number 410-VVCity of MERCEDCounty of MERCED, CaliforniaBrief Legal Description NORTHWEST CORNER OF PARCEL "A" AS SHOWN ON "PARCEL MAP FOR HAFA, LLC"  
80 PM 38 IN SECTION 17, T.7 S., R.14 E. MDB&M

### CORNER TYPE

Government Corner  Control   
 Meander  Property   
 Rancho  Other   
 Date of Survey 09-20-2012

### COORDINATES (Optional)

N. \_\_\_\_\_  
 E. \_\_\_\_\_  
 Zone \_\_\_\_\_ NAD27  NAD83   
 NAD83 Epoch \_\_\_\_\_  
 Elev. \_\_\_\_\_  
 Vert. Datum: NGVD29  NAVD88   
 Meas. Units: Metric  Imperial

Corner - Left as found  Found and tagged  Established  Reestablished  Rebuilt

Identification and type of corner found: Evidence used to identify or procedure used to establish or reestablish the corner:  
FOUND NAIL AND TAG LS 6406 IN LEAD PLUG IN CONCRETE DRIVEWAY AS SHOWN ON 80 PM 38, M.C.R.  
MONUMENT WAS DESTROYED WITH CONSTRUCTION PROJECT.

A description of the physical condition of the monument as found and as set or reset: \_\_\_\_\_

SET 1 1/2" ALUMINUM CAP STAMPED L.S. 7621 FLUSH IN CONCRETE  
PER CORNER RECORD 410-VV FILED ON JAN 30, 2012.

### SURVEYOR'S STATEMENT

This Corner Record was prepared by me or under my direction in conformance with  
 the Land Surveyor's Act on SEPTEMBER 20, 2012

Signed David D. Heirich P.L.S. or R.C.E. No. 7621



### COUNTY SURVEYOR'S STATEMENT

This Corner Record was received September 26, 2012

and examined and filed October 1, 2012

Signed J. Steven Reichmuth P.L.S. or R.C.E. No. 4895

Title Acting County Surveyor

County Surveyor's Comment \_\_\_\_\_

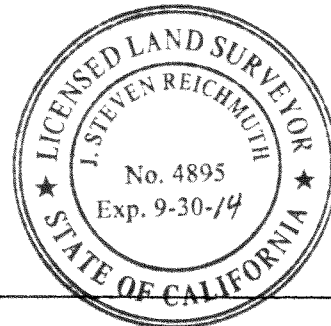

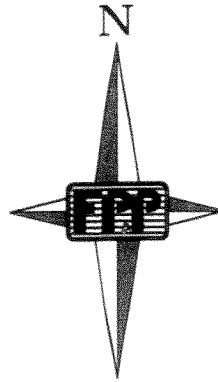

1" = 40'

**YOSEMITE AVENUE**

