

335A

CORNER RECORD

COUNTY OF Merced T. 9 S R. 15 E Mt. Diablo MERIDIAN CALIFORNIA
CORNER TYPE: GOV'T. CORNER [X] MEANDER [] RANCHO [] CONTROL [] OTHER []
CORNER IDENTIFICATION — DATE OF VISIT November 3, 19 77

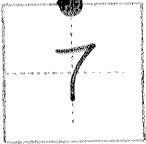

North 1/4 Corner, Section 7.

CORNER — LEFT AS FOUND [] FOUND AND TAGGED [] REESTABLISHED OBLITERATED CORNER [X] REBUILT []

PHYSICAL DESCRIPTION OF CORNER FOUND; EVIDENCE AND METHOD USED TO IDENTIFY OR REESTABLISH

Monument was proportioned in from the Northwest Corner, Section 7, 9/15 and the Northeast Corner, Section 7, 9/15.

PHYSICAL DESCRIPTION OF MONUMENTS REBUILT OR PERPETUATED

Set 1" O.D. iron pipe tagged L.S. 4156 with offset monuments (1" O.D. iron pipes tagged L.S. 4156) at 30 feet North on the Mid-Section line of Section 6, 9/15 and at 30 feet South on the Mid-Section line of Section 7, 9/15.

CALIFORNIA COORDINATE SYSTEM ORDER: FIRST [] SECOND [] THIRD []
STATIONS USED: NGS (USC & GS) [] STATE [] COUNTY [] OTHER [] STATION _____ STATION _____
ZONE _____ ELEVATION _____ NORTHINGS (Y) _____ EASTINGS (X) _____

SKETCH: (Include reference tie or witness points, remarks and topo of area)

Ties to Northerly offset Monument.

161.23 Southeast from well casing seam on Southside of old well casing.

154.93 Easterly from nail & shiner in Southside of utility pole.

Ties to Southerly offset Monument.

218.56 Southeast from well casing seam on Southside of old well casing.

167.84 Southeast from nail & shiner in Southside of utility pole.

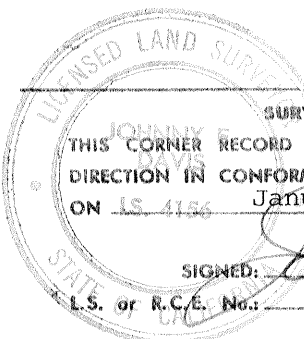

SURVEYOR'S CERTIFICATE

THIS CORNER RECORD WAS PREPARED BY ME OR UNDER MY DIRECTION IN CONFORMANCE WITH THE LAND SURVEYORS ACT ON 15 4156 January 30, 19 79

SIGNED: [Signature] 4156
L.S. or R.C.E. No.: _____

SEAL

COUNTY SURVEYOR'S CERTIFICATE

THE CORNER RECORD WAS RECEIVED _____ 19_____
AND EXAMINED AND FILED _____ 19_____
BY: _____
TITLE: _____

DOCUMENT No. 335A

STATEMENT ON BACK OF SHEET

YES [] NO []