

333-1

CO RNER RECORD

COUNTY OF Merced T. 9 S R. 15 E Mt. Diablo MERIDIAN CALIFORNIA

CORNER TYPE: GOV'T. CORNER [] MEANDER [] RANCHO [] CONTROL [] OTHER [X]
CORNER IDENTIFICATION -- DATE OF VISIT October 4, 1976

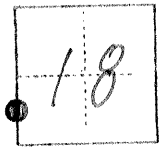

Northwest corner of Lot 25, Block 18 (Section 18) of the Bliss Ranch Subdivision on file in Volume 7 of plats at page 40, M.C.R.

CORNER -- LEFT AS FOUND [] FOUND AND TAGGED [] REESTABLISHED OBLITERATED CORNER [] REBUILT [X]

PHYSICAL DESCRIPTION OF CORNER FOUND; EVIDENCE AND METHOD USED TO IDENTIFY OR REESTABLISH

Found 3" x 3" redwood at 2' below road surface.

PHYSICAL DESCRIPTION OF MONUMENTS REBUILT OR PERPETUATED

Found 3" x 3" redwood at 2' below road surface. Set 1" O.D. pipe in center of redwood at road surface with plug L.S. 4156.

CALIFORNIA COORDINATE SYSTEM ORDER: FIRST [] SECOND [] THIRD []
STATIONS USED: NGS (USC & GS) [] STATE [] COUNTY [] OTHER [] STATION _____ STATION _____
ZONE _____ ELEVATION _____ NORTHINGS (Y) _____ EASTINGS (X) _____

SKETCH: (Include reference tie or witness points, remarks and topo of area)

- 23.81 Northeast from nail & shiner in fence post.
- 25.48 Southeast from nail & shiner in fence post.
- 36.24 Southeast from nail & shiner in fence post.
- 19.0 South from fence line West.
- 28.0 East from power line North-South.
- 22.0 East from fence line North-South.

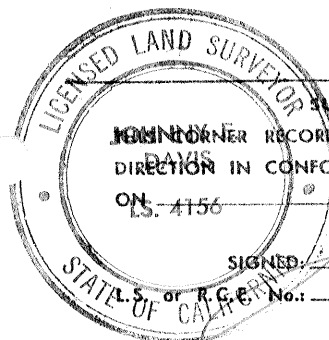

SURVEYOR'S CERTIFICATE
THIS CORNER RECORD WAS PREPARED BY ME OR UNDER MY DIRECTION IN CONFORMANCE WITH THE LAND SURVEYORS ACT ON L.S. 4156 January 29, 1978
SIGNED: *John D. Bais*
No.: 4156

SEAL

COUNTY SURVEYOR'S CERTIFICATE

THE CORNER RECORD WAS RECEIVED _____ 19_____
AND EXAMINED AND FILED _____ 19_____
BY: _____
TITLE: _____
DOCUMENT No. 333-G
STATEMENT ON BACK OF SHEET YES [] NO []