

# CORNER RECORD

COUNTY OF Merced T. 7 S. R. 12 E. N.D.B. MERIDIAN CALIFORNIA

CORNER TYPE: GOVT. CORNER  MEANDER  RANCHO  CONTROL  OTHER

CORNER IDENTIFICATION — DATE OF VISIT Sept 23 1983



*Southeast corner of Lot 16, of the Atwater Colony, recorded in Volume 2 of Maps, page 45*

CORNER — LEFT AS FOUND  FOUND AND TAGGED  REESTABLISHED OBLITERATED CORNER  REBUILT

PHYSICAL DESCRIPTION OF CORNER FOUND; EVIDENCE AND METHOD USED TO IDENTIFY OR REESTABLISH

*Found 3/4" outside diameter iron pipe, 3 feet long. Badly rusted and bent over.*

PHYSICAL DESCRIPTION OF MONUMENTS REBUILT OR PERPETUATED

*Set a 1" inside diameter iron pipe with County Surveyor tag in the position that the 3/4" o.d.i.p. occupied*

CALIFORNIA COORDINATE SYSTEM ORDER: FIRST  SECOND  THIRD

STATIONS USED: NGS (USC & GS)  STATE  COUNTY  OTHER  STATION \_\_\_\_\_ STATION \_\_\_\_\_

ZONE \_\_\_\_\_ ELEVATION \_\_\_\_\_ NORTHINGS (Y) \_\_\_\_\_ EASTINGS (X) \_\_\_\_\_

SKETCH: (Include reference tie or witness points, remarks and topo of area)

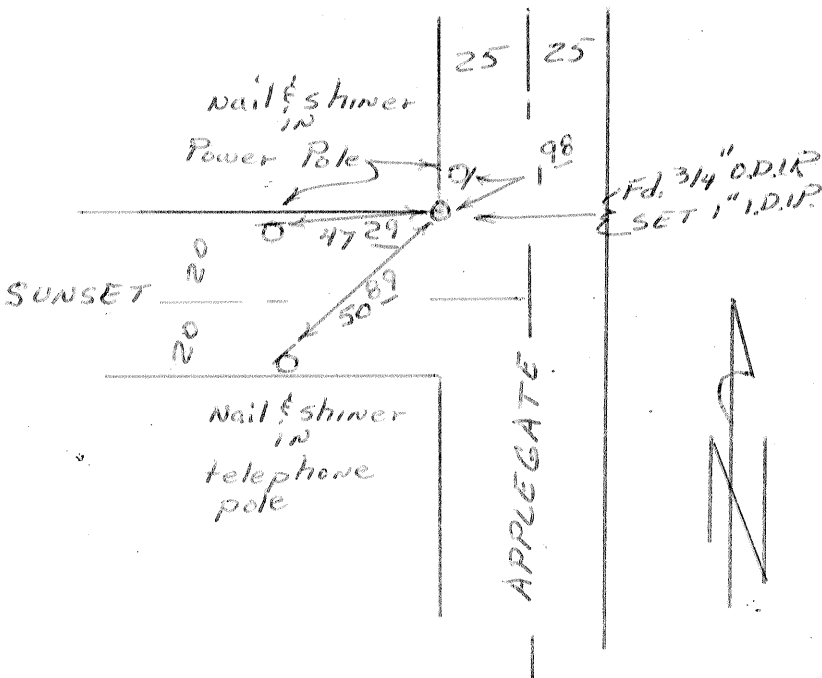

*TIES IN F.B. 716 p. 56*

*Prepared by  
Gary Grinder  
Party Chief  
Gary Grinder*

**SURVEYOR'S CERTIFICATE**

THIS CORNER RECORD WAS PREPARED BY ME OR UNDER MY DIRECTION IN CONFORMANCE WITH THE LAND SURVEYORS ACT ON \_\_\_\_\_ 19\_\_\_\_

SIGNED: \_\_\_\_\_

L.S. or R.C.E. No.: \_\_\_\_\_

SEAL

**COUNTY SURVEYOR'S CERTIFICATE**

THE CORNER RECORD WAS RECEIVED 10/16 1983 AND EXAMINED AND FILED 10/17 1983

BY: GARY GRINDER  
TITLE: County Surveyor

DOCUMENT No. 282-V

STATEMENT ON BACK OF SHEET

YES  NO