

138

CORN RECORD

COUNTY OF Merced T. 10S R. 9E MDB& MERIDIAN CALIFORNIA

CORNER TYPE: GOV'T. CORNER MEANDER RANCHO CONTROL OTHER

CORNER IDENTIFICATION — DATE OF VISIT 12-9-74 1975



COR No 138

CORNER — LEFT AS FOUND FOUND AND TAGGED REESTABLISHED OBLITERATED CORNER REBUILT

PHYSICAL DESCRIPTION OF CORNER FOUND; EVIDENCE AND METHOD USED TO IDENTIFY OR REESTABLISH

Fd 1" OD Iron pipe with plastic plug RCE 6888 as shown on Parcel Map Bk. ²⁵ ³⁵ Pg. 25 County of Merced.

PHYSICAL DESCRIPTION OF MONUMENTS REBUILT OR PERPETUATED

CALIFORNIA COORDINATE SYSTEM ORDER: FIRST SECOND THIRD
STATIONS USED: NGS (USC & GS) STATE COUNTY OTHER STATION _____ STATION _____
ZONE _____ ELEVATION _____ NORTHINGS (Y) _____ EASTINGS (X) _____

SKETCH: (Include reference tie or witness points, remarks and topo of area)

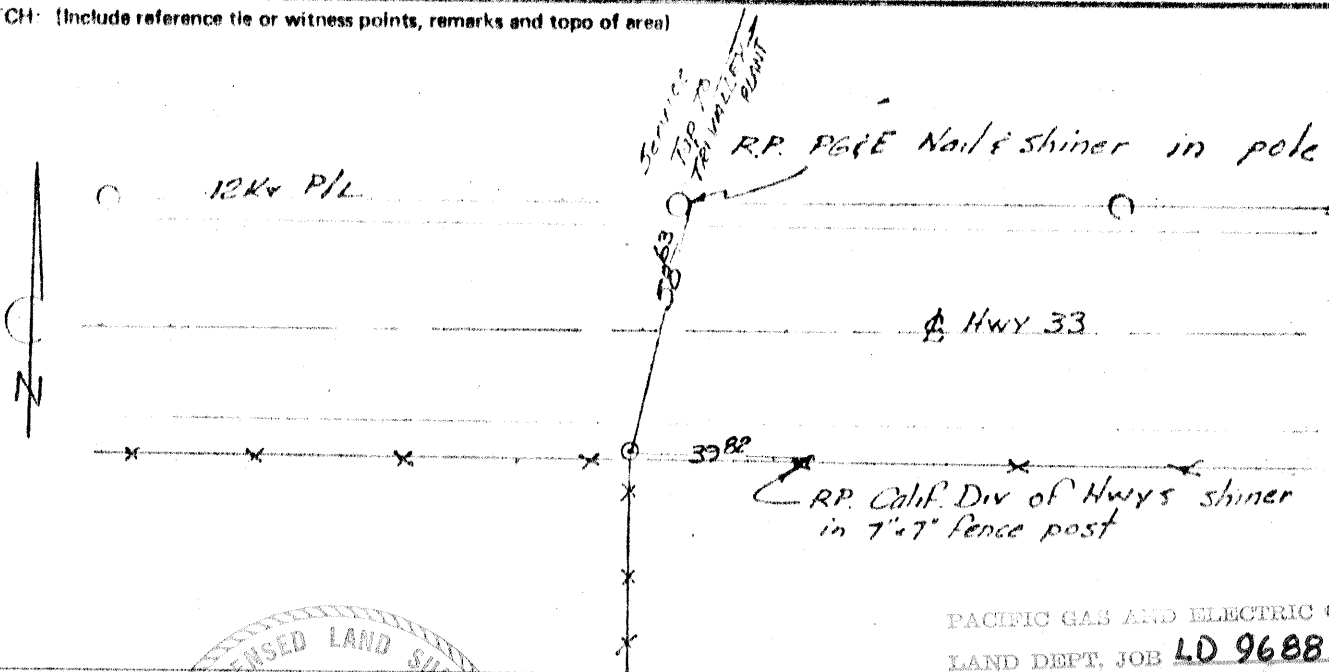

PACIFIC GAS AND ELECTRIC CO.
LAND DEPT, JOB LD 9688

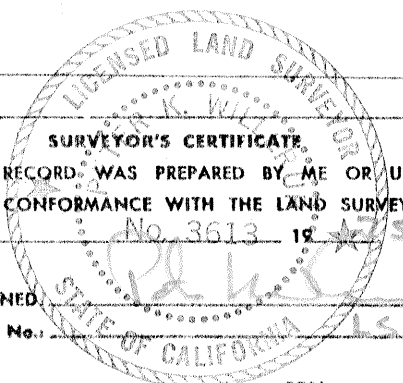

SURVEYOR'S CERTIFICATE
THIS CORNER RECORD WAS PREPARED BY ME OR UNDER MY DIRECTION IN CONFORMANCE WITH THE LAND SURVEYORS ACT ON 1-2 No. 3613 1975
SIGNED: _____
L.S. or R.C.E. No. LS 3613

COUNTY SURVEYOR'S CERTIFICATE
THE CORNER RECORD WAS RECEIVED 2-18 1975
AND EXAMINED AND FILED 2-19 1975
BY: J. W. ...
TITLE: Co Surveyor
DOCUMENT No. 138
STATEMENT ON BACK OF SHEET YES NO