

#136

CORN RECORD

COUNTY OF Merced T. 10S R. 9E MDB& MERIDIAN CALIFORNIA

CORNER TYPE: GOV'T. CORNER MEANDER RANCHO CONTROL OTHER

CORNER IDENTIFICATION — DATE OF VISIT 11-25 19 74

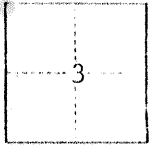

COR # 136

CORNER — LEFT AS FOUND FOUND AND TAGGED REESTABLISHED OBLITERATED CORNER REBUILT

PHYSICAL DESCRIPTION OF CORNER FOUND; EVIDENCE AND METHOD USED TO IDENTIFY OR REESTABLISH

1-3/4" O.D. iron pipe DN. 0⁶ - F.D. hole in centerline Hwy (33) - On fence line projection from the south.

PHYSICAL DESCRIPTION OF MONUMENTS REBUILT OR PERPETUATED

CALIFORNIA COORDINATE SYSTEM ORDER: FIRST SECOND THIRD
STATIONS USED: NGS (USC & GS) STATE COUNTY OTHER STATION _____ STATION _____
ZONE _____ ELEVATION _____ NORTHINGS (Y) _____ EASTINGS (X) _____

SKETCH: (Include reference tie or witness points, remarks and topo of area)

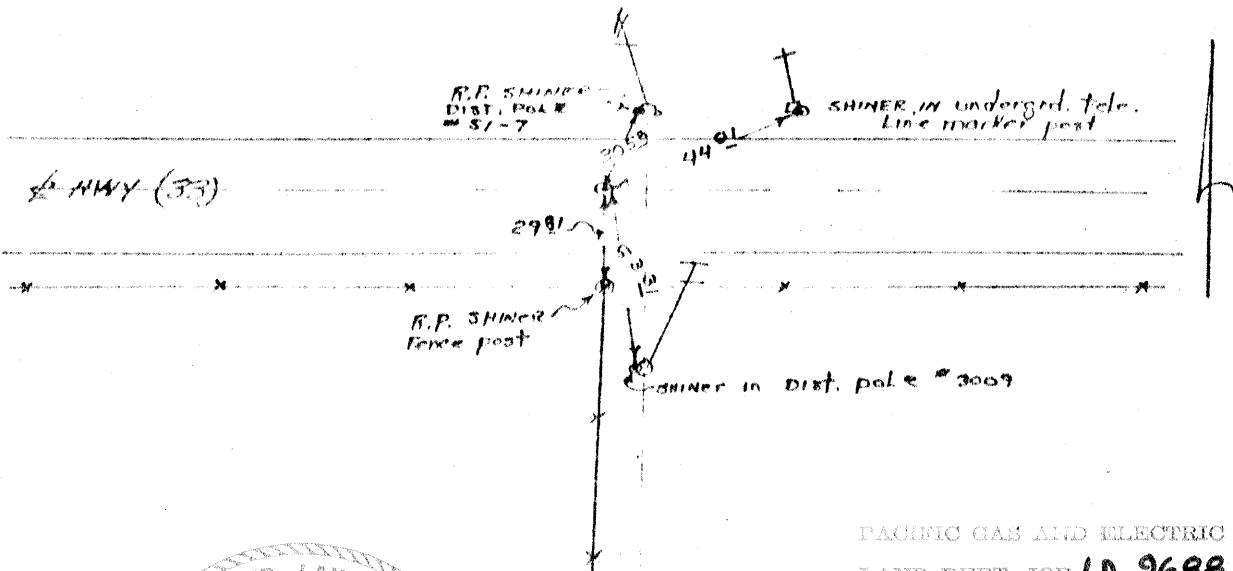

PACIFIC GAS AND ELECTRIC CO.
LAND DEPT. JOB LD 9688

SURVEYOR'S CERTIFICATE

THIS CORNER RECORD WAS PREPARED BY ME OR UNDER MY DIRECTION IN CONFORMANCE WITH THE LAND SURVEYORS ACT ON 1-21 No. 8613 19 75

SIGNED: [Signature]
L.S. or R.C.E. No. LS 3813

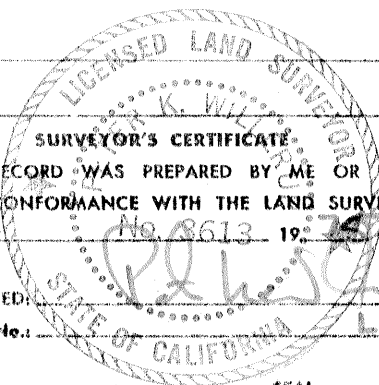

COUNTY SURVEYOR'S CERTIFICATE

THE CORNER RECORD WAS RECEIVED 2-18 19 75
AND EXAMINED AND FILED 2-19 19 75

BY: [Signature]
TITLE: Co Surveyor

DOCUMENT No. 136

STATEMENT ON BACK OF SHEET

YES NO