

CORNER RECORD

Document Number 134

City of SANTA NELLA

County of MERCED

California

Brief Legal Description NE. CORNER OF SECTION 6; T. 10S.; R. 9E. MDM

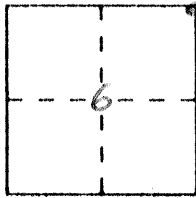

CORNER TYPE

Government Corner Control
Meander Property
Rancho Other
Date of Survey 1-23-97

**COORDINATES
(Optional)**

N. _____
E. _____
Zone _____ Datum _____
Elev. _____

Corner — Left as found Found and tagged Established Reestablished Rebuilt

Identification and type of corner found: Evidence used to identify or procedure used to establish or reestablish the corner: FOUND 1" I.P. WITH YELLOW PLUG, STAMPED L.S. 4323

AS SHOWN ON 41-SM-33

A description of the physical condition of the monument as found and as set or reset: FOUND POINT IS IN GOOD PHYSICAL CONDITION AND LEFT AS IS

SURVEYOR'S STATEMENT

This Corner Record was prepared by me or under my direction in conformance with the Land Surveyors' Act on JAN 23 1997.

Signed Peter Hernandez L.S. or R.C.E. Number 6949
Expires 9-30-97

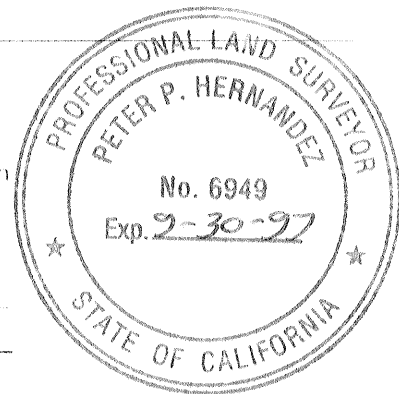

COUNTY SURVEYOR'S STATEMENT

This Corner Record was received 2-14 1997 and examined and filed 2-19 1997.

Signed Roy L. Turney Title DEP. CO. SUR.

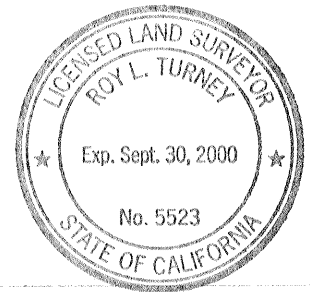

County Surveyor's Comment

NE COR SECT 6
T10S R9E MDM



SOUTH BOUND

SANTA NELLA

NORTH BOUND

POWER POLE

FD NAIL & TAG
LS 4324

FD 1" IRON PIPE
w/ YELLOW PLASTIC
PLUG DOWN 12"
"LS 4323"

SCRIBED "+" IN
CONC BASE OF
ELECTROLIER

HENRY MILLER RD

FD SCRIBED "+"
IN CONC CURB (TOP)

McDONALD'S
RESTAURANT

EXISTING CONC CURB
& SIDEWALK

STATE RT 93

The ties shown hereon are for the purpose of perpetuating the monumentation currently existing. No attempt was made to determine the validity of the monuments or their proper location in relation to legal property lines in the area.