

CORNER RECORD

Document Number 77

City of _____ County of Merced, California

Brief Legal Description S.W. Corner Section 30 7/15

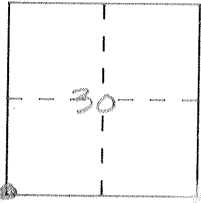

CORNER TYPE

Government Corner Control
Meander Property
Rancho Other
Date of Survey 8-10-92

COORDINATES (Optional)

N. _____
E. _____
Zone _____ Datum _____
Elev. _____

Corner — Left as found Found and tagged Established Reestablished Rebuilt

Identification and type of corner found: Evidence used to identify or procedure used to establish or reestablish the corner:

A description of the physical condition of the monument as found and as set or reset: Fd. 3/8" rebar in monument well.

OK - 8-31-93

F.B. 658-12

SURVEYOR'S STATEMENT

This Corner Record was prepared by me or under my direction in conformance with the Land Surveyors' Act on Sept. 3 19 93.

Signed [Signature] L.S. or R.C.E. Number _____

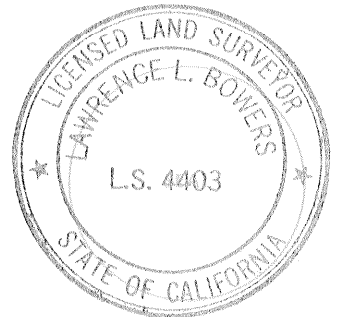

COUNTY SURVEYOR'S STATEMENT

This Corner Record was received 9-3 19 93 and examined and filed 9-7 19 93.

Signed [Signature] Title Dep. Co. Surveyor

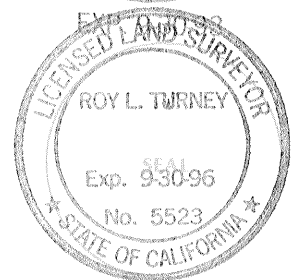

County Surveyor's Comment _____

SEC 25

SEC 30

SET NAIL & SHINER
IN SW SIDE OF
POWER POLE.

DRIVE



SET COTTON SPINDLE
IN E STRIPES.

CHILDS AVENUE

38.63'

52.25'

FD. 5/8" RE-BAR IN
MON. BOX SW COR.
SEC. 30 3/5; SE COR.
SEC. 25 3/4.

CHIS. -|- ON TOP OF
MIDDLE OF EAST
SIDE OF CONC.
IRR. BOX NEAR
WELL PUMP.

80.48'

83.65'

FD. NAIL &
SHINER IN SE
SIDE OF TRANS
POLE.

ARBOLEDA

SEC 36

SEC 31

POINTS WERE TIED OUT PRIOR TO PAVING
EFFORT BY MERCED COUNTY DEPARTMENT
OF PUBLIC WORKS