

CORNER RECORD

Document Number 67

City of _____ County of Merced, California

Brief Legal Description Section Corner, Sections 31 & 32, T5S, R1E or Sections 5 & 6, T6S, R1E, MDM

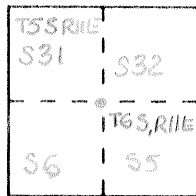

CORNER TYPE

Government Corner Control
 Meander Property
 Rancho Other
 Date of Survey JUNE 23, 24, 1998

COORDINATES (Optional)

N. _____
 E. _____
 Zone _____ Datum _____
 Elev. _____

Corner — Left as found Found and tagged Established Reestablished Rebuilt

Identification and type of corner found: Evidence used to identify or procedure used to establish or reestablish the corner: FOUND 1" IP WITH BRASS TAG "CAL TRANS" (DOWN 0.6')

A description of the physical condition of the monument as found and as set or reset: good

SURVEYOR'S STATEMENT

This Corner Record was prepared by me or under my direction in conformance with the Land Surveyors' Act on JUNE 23, 19 98.

Signed Robin L. Wickline L.S. or R.C.E. Number L7026 Expires 6/30/02

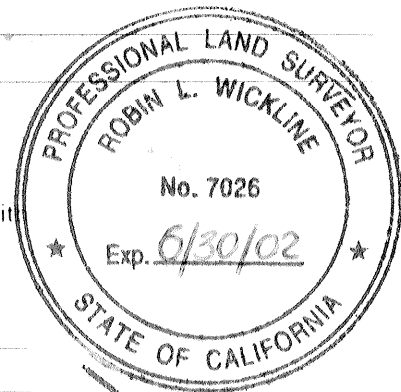

COUNTY SURVEYOR'S STATEMENT

This Corner Record was received JULY 20 19 98 and examined and filed JULY 27 19 98.

Signed Roy L. Turney Title DEP. CO. SUR.

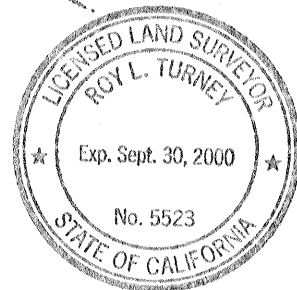

County Surveyor's Comment _____

2800875

Ref: 7 PM 36 MCR
12 PM 26 MCR

LEGEND:

- FOUND 1" IP WITH BRASS TAG "CAL TRANS" (DOWN 0.6')
- SET CONCRETE NAIL WITH BRASS TAG "CAL TRANS" (FLUSH W/AC) AS REFERENCE

NOTE: UNLESS OTHERWISE NOTED, ALL DISTANCES SHOWN ARE MEASURED GROUND DISTANCES

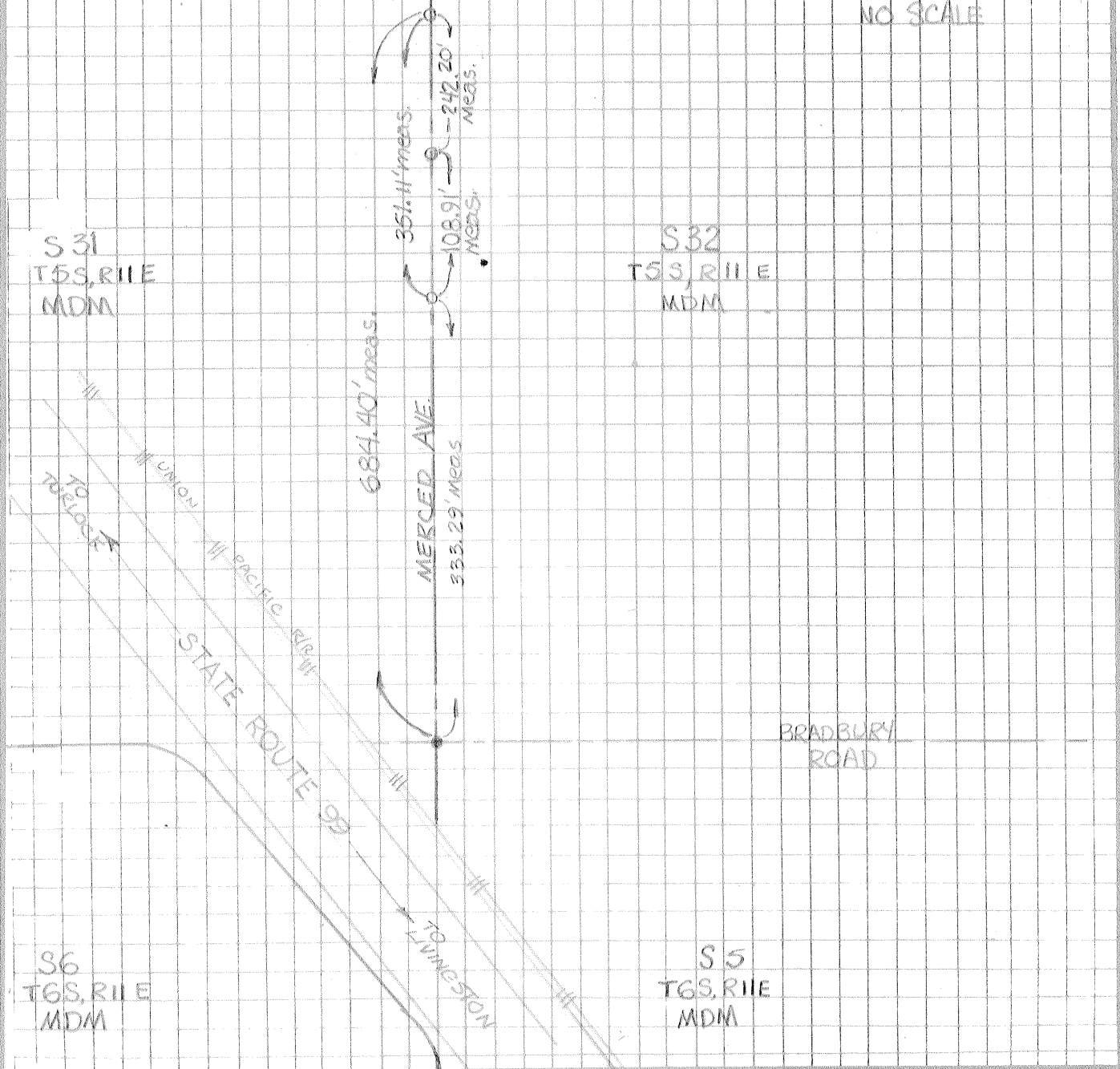
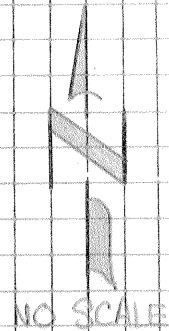

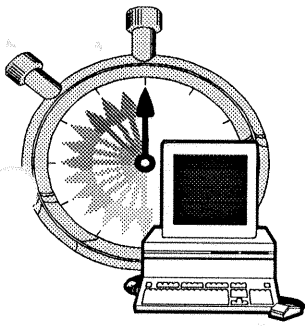

GARY GRINDER L.S.

COMPUTER RESEARCH OF RECORDS

DATA BASES OF MERCED COUNTY
RECORD OF SURVEYS PARCEL MAPS
OFFICIAL PLATS

MERCED COUNTY SURVEYOR'S RECORDS ON FILE

7/23/98

<u>CO SURV NU</u> 67	INTERSECTION ROUTE	BRADBURY-MERCED	
MONUMENT	REFERENCE	DATE	MON #
4" X 4" POST SET BY FEO. S. MANUEL, SET PIPE	5-270	Mar 1, 1907	51131SE
4 X 4 RED. POST ON CL	OP 3 PG 44	Sep 19, 1907	51131SE
OLD 4 X 4 POST, COR TO SEC'S 5 & 6	OP 3 PG 48	Jan 6, 1908	51131SE
OLD 4" X 4" POST ON TOWNSHIP LINE	5-408	Aug 23, 1916	51131SE
HUB & TACK ON CL, 2" X 2" PIN STAKE IN 8" CONC PIPE	OP 8 PG 2	Feb 18, 1922	51131SE
FD 2" IP ON CL	RS 2 PG 60	Oct 17, 1946	51131SE
FD 2" IP, NE COR SEC 6	RS 2 PG 78	May 4, 1953	51131SE
FD 2" IP, NE COR SEC 6	RS 2 PG 79	May 14, 1953	51131SE
FD 2" IP, NE COR SEC 6	RS 6 PG 22	Nov 2, 1964	51131SE
FD 2" IP, NW COR SEC 5	PM 12 PG 26	Oct 21, 1970	51131SE
FD 2" IP, SW COR SEC 32	RS 32 PG 17	Dec 14, 1994	51131SE
FD 1" IP W/BRASS TAG "CALTRANS"	COR REC 67	Jun 23, 1998	51131SE

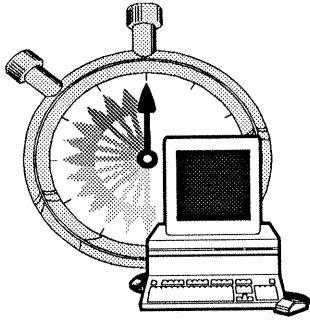

GARY GRINDER, L.S.
COMPUTER RESEARCH OF RECORDS

DATA BASES OF MERCED COUNTY
RECORD OF SURVEYS PARCEL MAPS
OFFICIAL PLATS

MERCED COUNTY ROAD DEPARTMENT FIELD BOOKS

CO_SURV_NU **67**

INTERSECTION BRADBURY-MERCED
ROUTE

MONUMENT	REFERENCE	DATE	MON #
FD 2" IP SEC COR, TIE	FB 43 PG 5, 8	3/17/1954	51131SE
FD 1/2" IP, TIE	FB 44 PG 76	3/5/1956	51131SE
FD 2" X 2" HUB OVER 2" IP SEC COR, TIE	FB 43 PG 8	5/8/1973	51131SE