

# CORNER RECORD

Document Number 66 K

City of \_\_\_\_\_

County of Merced, California

Brief Legal Description T.5 S., R.11 E. M.D.M.

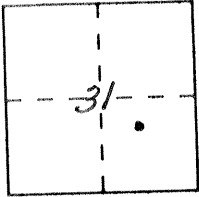

### CORNER TYPE

Government Corner  Control   
 Meander  Property   
 Rancho  Other   
 Date of Survey 2-16-99

### COORDINATES (Optional)

N. 346,936.51  
 E. 1,912,848.73  
 Zone 3 Datum CCS 27  
 Elev. \_\_\_\_\_

Corner — Left as found  Found and tagged  Established  Reestablished  Rebuilt   
1-05-00

Identification and type of corner found: Evidence used to identify or procedure used to establish or reestablish the corner: Found corner monument - No reference

Monument will be destroyed by Turlock Irrigation Pipeline Relocation

A description of the physical condition of the monument as found and as set or reset: Found 3/4" iron pipe with brass tag stamped RCE 22339 - witness T-Post along side.

Reestablished with 1" iron pipe & plug stamped "CALIF. DOT."

### SURVEYOR'S STATEMENT

This Corner Record was prepared by me or under my direction in conformance with the Land Surveyors' Act on Feb 16 19 99.

Signed William G. Kosky L.S. or R.C.S. Number 6367  
 License Expiration Date 12-31-02

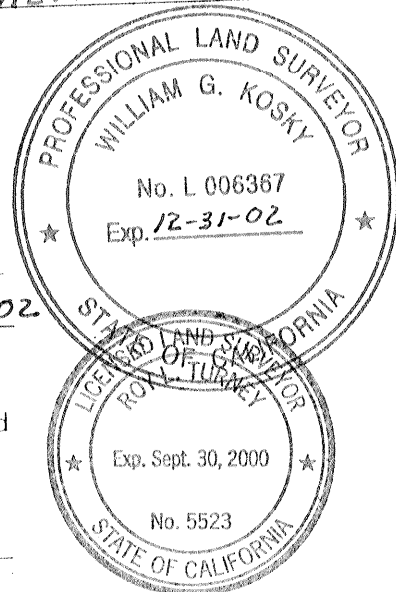

### COUNTY SURVEYOR'S STATEMENT

This Corner Record was received MARCH 15 <sup>2000</sup>/<sub>19</sub> and examined and filed APRIL 20 <sup>2000</sup>/<sub>19</sub>.

Signed Roy L. Tunney Title DEP. CO. SUR.

County Surveyor's Comment APPEARS TO BE N.E. COR. PARCEL #1 OF 80-PM-42

N  
no scale

State R/W  
R=970'

Private Property

Fd 1" Iron Pipe with  
Red Plug Stamped Caltrans Mon

(Caltrans Project Control Mon #139)

25.41 ft

Fd T-Post

Fd 3/4" Iron  
Pipe with  
Brass Tag  
Stamped  
RCE 22339

28.97 ft

TID Canal

Fd 5/8" Rebar in  
gate Structure

Monument destroyed  
by construction -  
Reset 1" iron pipe  
with plug stamped  
CALIF. DOT.  
1-05-00