

CORNER RECORD

Document Number 66 J

City of _____ County of Merced, California

Brief Legal Description Centerline Monument - Early Dawn Rd. - Clausen Rd
T.S.S., R.I.E. M.D.M.

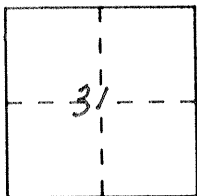

CORNER TYPE

Government Corner Control
Meander Property
Rancho Other
Date of Survey 2-18-99

COORDINATES
(Optional)

N. See sketch - Pg 2
E. _____
Zone 3 Datum CGS 27
Elev. _____

Corner — Left as found Found and tagged Established Reestablished Rebuilt
1-20-00

Identification and type of corner found: Evidence used to identify or procedure used to establish or reestablish the corner: Fd 1" Iron Pipe at PC and PT of Early Dawn - Clausen Rd curve. - No reference

Monuments will be destroyed by highway construction
Reestablished with 1" iron pipe and plug stamped "CALIF. DOT."

A description of the physical condition of the monument as found and as set or reset: Good condition - Flush with pavement

SURVEYOR'S STATEMENT

This Corner Record was prepared by me or under my direction in conformance with the Land Surveyors' Act on Feb 18 19 99.

Signed William G. Kosky L.S. or R.C.S. Number 6367
License Expiration Date 12-31-02

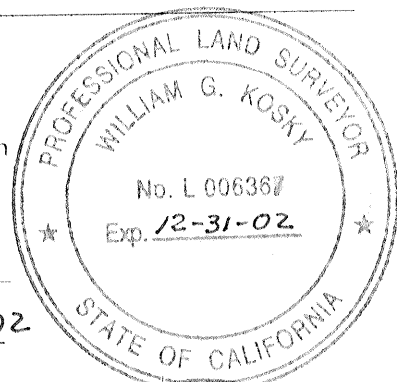

COUNTY SURVEYOR'S STATEMENT

This Corner Record was received 3-15 ²⁰⁰⁰/₁₉ and examined and filed 4-20 ²⁰⁰⁰/₁₉.

Signed Roy L. Turney Title Dep Co. Sur.

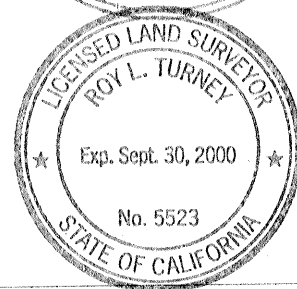

County Surveyor's Comment _____

↑
N
no scale

Q. Clausen Rd

Fd 1" Iron Pipe
N 347,836.15
E 1,912,085.53

Destroyed by Construction
Reset 1" iron pipe with
plug stamped CALIF. DOT.

Fd 1" Iron Pipe
N 347,696.45
E 1,912,180.40

Destroyed by Construction -
Reset 1" iron pipe with
plug stamped CALIF. DOT.

Q. Early Dawn Rd

401.71'
243.71'

Meas.
171° 36' 33"

Meas.
160° 30' 51"

Set 1" Iron Pipe w/yellow
Plug Stamped "Calif DOT"

N 41° 30' 08" W
386.50'

Set 1" Iron Pipe
w/yellow Plug Stamped
"Calif DOT"