

CORNER RECORD

Document Number 66 J
County of Merced, California

City of _____
Brief Legal Description Centerline beginning and end curve of transition from Early Dawn Road to Clausen Rd.

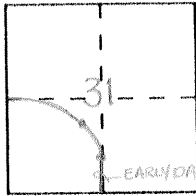

CORNER TYPE

COORDINATES (Optional)

Government Corner Control
Meander Property
Rancho Other
Date of Survey JUNE 24, 1998

N. _____
E. _____
Zone _____ Datum _____
Elev. _____

Corner — Left as found Found and tagged Established Reestablished Rebuilt

Identification and type of corner found: Evidence used to identify or procedure used to establish or reestablish the corner: found 1" IP open (flush in A/C Pmnt.)

A description of the physical condition of the monument as found and as set or reset: good

SURVEYOR'S STATEMENT

This Corner Record was prepared by me or under my direction in conformance with the Land Surveyors' Act on June 24 1998.

Signed Robin L. Wickline L.S. or R.C.E. Number LS 7026
Expires 6/30/02

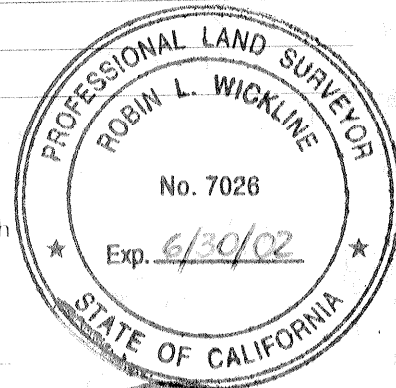

COUNTY SURVEYOR'S STATEMENT

This Corner Record was received JULY 20 1998 and examined and filed JULY 27 1998.

Signed Roy L. Turney Title DEP. CO. SUR.

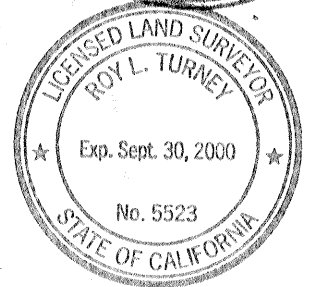

County Surveyor's Comment

SR 980089

