

CORNER RECORD

Agency Index 15-J
Document Number _____

City of _____ County of Merced, California
Brief Legal Description South Line of Parcel 2 of P.M. 102-25

CORNER TYPE

COORDINATES (Optional)

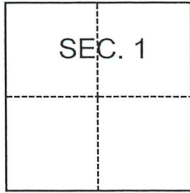

T. 7 S., R. 13 E.

- Government Corner
- Meander
- Rancho
- Control
- Property
- Other

Date of Survey March 20, 2018

N. _____ E. _____
 Elevation _____
 Units Metric U.S. Survey Foot
 Horizontal Datum _____
 Zone _____ Epoch Date _____
 Vertical Datum _____
 Complies with Public Resources Code §§8801-8819
 Complies with Public Resources Code §§8890-8902

PLS Act Ref.: 8765(d) 8771 8773 Other:
 Corner/Monument: Left as found Established Rebuilt Pre-Construction
 Found and tagged Reestablished Referenced Post-Construction

Narrative of corner identified and monument as found, set, reset, replaced, or removed:

See sheet #2 for description(s):

Found corners as shown and described on Page 2.

Re-established missing monument at SE Corner of Parcel 2 on line between found E 1/4 Corner to north and found SE Corner to south as shown, at prorated distance of 1203.77 feet from E 1/4 Cor.

Re-established 1/16 Section Corner location for re-establishment of missing monument at SW Corner of Parcel 2. Prorated SW Corner of parcel 2 at prorated distance of 1211.18 feet.

SURVEYOR'S STATEMENT

This Corner Record was prepared by me or under my direction in conformance with
 the Professional Land Surveyors' Act on February 8, 2019
 Signed [Signature] P.L.S. or R.C.E. No. 8247

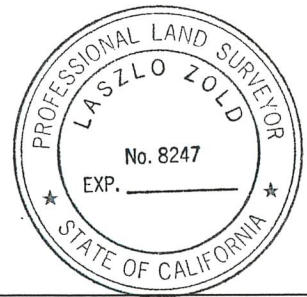

COUNTY SURVEYOR'S STATEMENT

This Corner Record was received FEBRUARY 11, 2019
 and examined and filed FEBRUARY 11, 2019
 Signed Zachary T. Janz P.L.S. or R.C.E. No. 8664
 Title COUNTY SURVEYOR



County Surveyor's Comment

