

CORNER RECORD

Agency Index 14-D

Document Number _____

City of MERCED

County of MERCED, California

Brief Legal Description LOT 49 OF BELLEVUE RANCH EAST VILLAGE Q, 74-OP-48

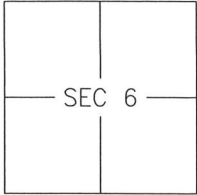

T7S/R14E

CORNER TYPE

- Government Corner Control
 Meander Property
 Rancho Other

Date of Survey 2018-06-28

COORDINATES (Optional)

- N. _____ E. _____
 Elevation _____
 Units Metric U.S. Survey Foot
 Horizontal Datum _____
 Zone _____ Epoch Date _____
 Vertical Datum: _____
 Complies with Public Resources Code §§8801-8819
 Complies with Public Resources Code §§8890-8902

PLS Act Ref.: 8765(d) 8771 8773 Other: _____

Corner/Monument: Left as found Established Rebuilt Pre-Construction
 Found and tagged Reestablished Referenced Post-Construction

Narrative of corner identified and monument as found and set or reset:
 See sheet #2 for description(s):

SURVEYOR'S STATEMENT

This Corner Record was prepared by me or under my direction in conformance with
 the Land Surveyor's Act on 13 July, 2018.
 Signed [Signature] P.L.S. or R.C.E. No.: 8040

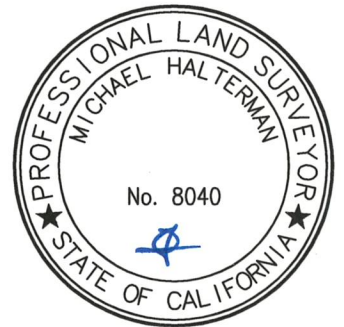

COUNTY SURVEYOR'S STATEMENT

This Corner Record was received JULY 17, 2018 and examined
 and filed JULY 18, 2018.
 Signed Zachary T. Janz P.L.S. or R.C.E. No.: 8664
 Title COUNTY SURVEYOR



County Surveyor's Comment _____



REFERENCE

(A) BELLEVUE RANCH EAST VILLAGE Q, VOLUME 74 OF OFFICIAL PLATS
PAGES 48-58

LEGEND:

- FOUND 3/4" IRON PIPE MONUMENT WITH TAG "LS 4914" PER (A)
- SET 3/4" IRON PIPE, TAGGED LS 8040, OR AS NOTED

SCALE



1" = 30'